



2/47 Burton Street CONCORD, NSW



It's Time For A Makeover

Unit 2 is a spacious approx.149sqm lot with a favoured N/E aspect. In good company this elevated ground level unit is situated at the rear of a boutique block of six, three bedroom units. In pristine, original condition presents as:

- * Three spacious bedrooms, two with built-in robes, the main with walk-in robe, ensuite and opening to a north facing balcony with a pleasant outlook
- * Air conditioned combined living/dining room with an easterly aspect opens to one of two balconies (main balcony)
- * Neatly presented kitchen
- * Well maintained bathroom with a separate shower
- * Large internal laundry

Located approximately 1 kilometre from Strathfield train station/buses and just as close t

Council Rates: \$255.95 p/q

Water Rates: \$171.00 p/q

Strata Rates: \$606.80 p/q

Rita Gibson

0418 436 854

Claudine Cornall

0408 436 884

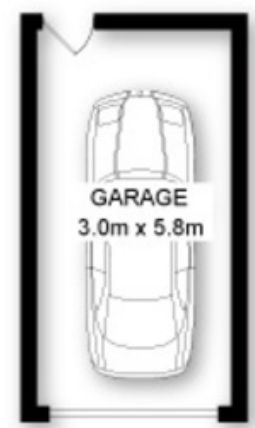
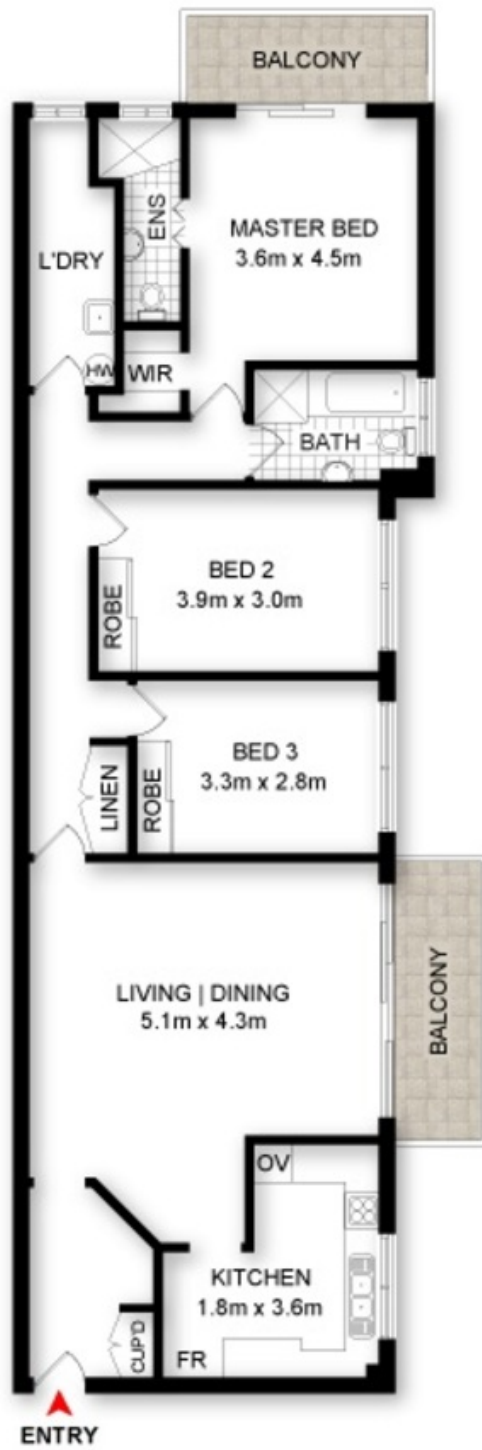

DISCLAIMER: THIS IS FOR ILLUSTRATIVE PURPOSES ONLY. ALL DIMENSIONS ARE APPROXIMATE AND IT DOES NOT CONSTITUTE PART OF ANY LEGAL DOCUMENTS.

ADDRESS:
2/47 BURTON STREET
CONCORD, NSW



2/47 Burton Street
 FLOORPLAN BY www.sosphotography.com.au