

6/19-21 Ilka Street LILYFIELD, NSW



### Unique Hidden Gem

Council Rates: \$281.37 per quarter approximately  
 Water Rates \$277.73 per quarter approximately plus usage  
 Strata Levies: \$753.00 per quarter approximately

**Council Rates:** \$281.37 p/q  
**Water Rates:** \$277.73 p/q  
**Strata Rates:** \$753.00 p/q

**Rosalie Gordon**  
 0416 198 261

**Mark Gordon**  
 0414 797 779



Internal: 80.00m<sup>2</sup>  
 Outdoor: 47.63m<sup>2</sup>  
 Carspace: 12.75m<sup>2</sup>  
 Total: 140.38m<sup>2</sup>  
 Lot: 95.65m<sup>2</sup>

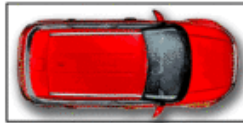

Carspace  
5.1x2.5m

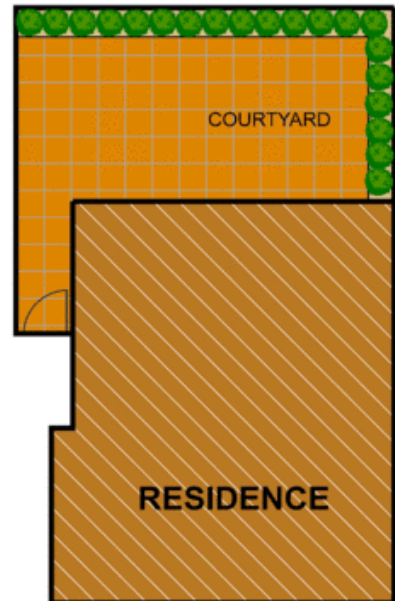
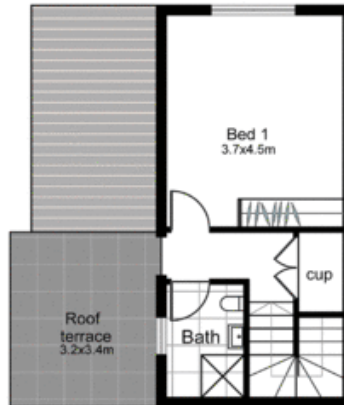

GROUND FLOOR 0 1 2 3 4 5m

FIRST FLOOR

SITE PLAN  
 (not to scale)

DISCLAIMER: THIS IS FOR ILLUSTRATIVE PURPOSES ONLY.  
 ALL DIMENSIONS ARE APPROXIMATE AND IT DOES NOT  
 CONSTITUTE PART OF ANY LEGAL DOCUMENTS.

ADDRESS:

6/19-21 ILKA STREET, LILYFIELD

FLOORPLAN BY [www.sosphotography.com.au](http://www.sosphotography.com.au)