

**191 Elizabeth Street Croydon NSW**

3 1 1

This charming 3 bedroom terrace includes security grills on all doors and windows, carpet, roller blinds & light fittings.

**View :** <https://www.planetproperties.com.au/lease/nsw/inner-west/croydon/residential/house/7603996>

**Features:**

- \* 3 large bedrooms ( 2 with built in robes)
- \* Study/nursery
- \* Spacious living/dining room
- \* As New kitchen
- \* Upstairs bathroom
- \* Internal laundry with 2nd toilet
- \* Outdoor undercover entertaining area with courtyard
- \* Carport with rear lane access

Located close to the Croydon Village, Croydon train station (550m), Ashfield train station (850m), private and public schools, Ashfield Mall & brand new Ashfield Aquatic Centre.



**Rita Gibson**  
02 9747 8888



**Jhi Cornall**  
0297478888

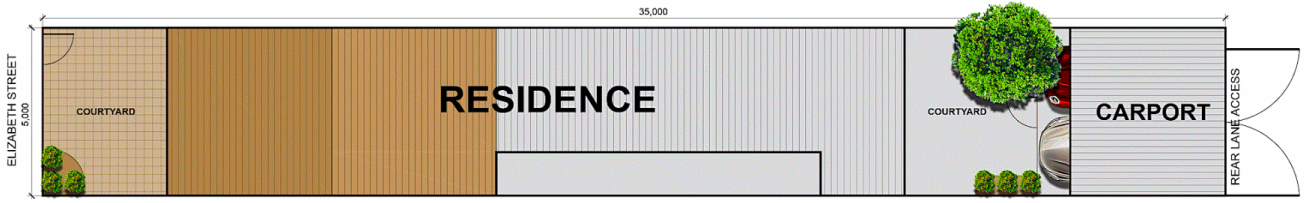

SITE PLAN (not to scale)

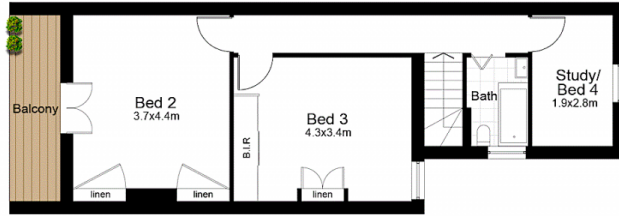

Ground floor	63.00m <sup>2</sup>
First floor	47.00m <sup>2</sup>
Outdoor	27.00m <sup>2</sup>
Carport	28.00m <sup>2</sup>
<b>Total area</b>	<b>165.00m<sup>2</sup></b>
Lot (aprox.)	226.00m <sup>2</sup>

FIRST FLOOR

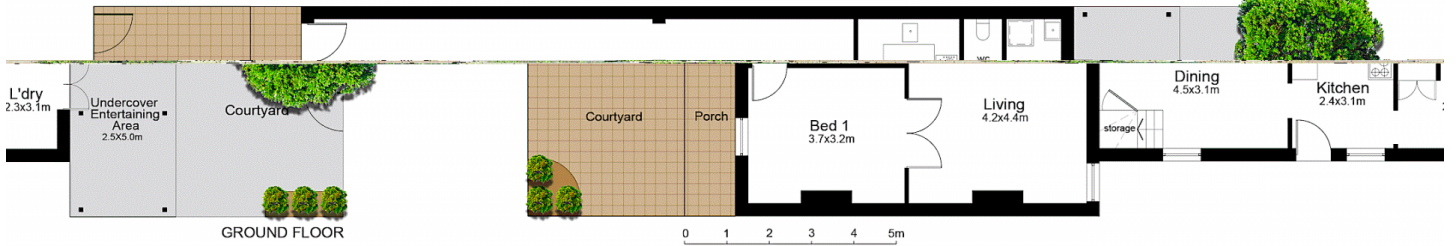

GROUND FLOOR

191 ELIZABETH STREET, CROYDON, NSW 2132

DISCLAIMER: THIS IS FOR ILLUSTRATIVE PURPOSES ONLY. ALL DIMENSIONS ARE APPROXIMATE AND IT DOES NOT CONSTITUTE PART OF ANY LEGAL DOCUMENTS.

ADDRESS:

191 ELIZABETH STREET

FLOORPLAN BY [www.sosphotography.com.au](http://www.sosphotography.com.au)